

# TECHNICAL DATA SHEET

# Waterproofing Kit

10/08/25

Kelmore's Waterproofing Kit includes everything you need for effective moisture protection: Waterproofing Paste, Reinforcing Tape, Internal Corners and a pair of disposable gloves.

Waterproofing Paste is a ready to use, rapid drying liquid membrane designed to protect moisture-sensitive wall and floor backgrounds prior to tiling. When used with Kelmore's reinforcing tape and preformed corners, this polymer-modified paste creates a highly flexible waterproof barrier that shields backgrounds from potential water damage. Requiring only a single coat application, this self-priming product allows tiles to be fixed just 3 hours after application.



## Technical Information

Kit contents	Waterproofing Paste 2.5kg Reinforcing Tape 10m Internal Corners x 2 Pair of gloves	
Paste colour	Light Grey	
Application temperature (air and background)	≥ 5°C	
Application thickness	Approximately 1mm	
Tile after (@20°C)	3 hours	
Consumption per mm thickness	0.38kg/m <sup>2</sup>	
Approximate coverage	8m <sup>2</sup>	

### Areas of Use

Walls and Floors	Interior	Domestic and Commercial	Showers	Wet Rooms
------------------	----------	-------------------------	---------	-----------

### Suitable Wall Backgrounds

Cement:Sand Render	Plaster (Finish Coat)	Plasterboard	Tile Backer Boards
--------------------	-----------------------	--------------	--------------------

### Suitable Floor Backgrounds

Cement:Sand Screed (inc. Heated)	Concrete	Calcium Sulphate/ Anhydrite Screed (inc. Heated)	Existing Ceramic, Porcelain, and Natural Stone Tiles	Tile Backer Boards
----------------------------------	----------	--	--	--------------------

## BACKGROUND AND SURFACE PREPARATION

Backgrounds must be sufficiently dry and strong enough to carry the total weight being applied. Ensure any falls in the substrate have been constructed to the required gradients and all drainage is capable of efficiently handling the expected rate of water flow. All surfaces must be clean, sound, flat and free from contaminants that could impair adhesion, such as dust, dirt, oil, grease, laitance, and curing agents. Timber bases must be rigid, stable and adequately ventilated. They should support both static and dynamic loads without deflection and be covered with an appropriate intermediate layer.

Very porous backgrounds should be primed with one coat of PrimeMore Universal, diluted 1:3 with clean water. If preferred, other porous backgrounds may also be primed using the same dilution. In all cases, allow the primer to dry fully before applying Waterproofing Paste.

### Guidance notes on suitable wall backgrounds

#### CEMENT:SAND RENDER

Must be true and firmly bonded to the background. Prevent from rapid drying and allow to air dry for at least 2 weeks.

#### PLASTER

Tiles should only be fixed to a finish coat of plaster. Ensure it is dry, sound, well adhered and free from any loose or weak material. Where a backing coat and a finish coat have been applied, allow a minimum of 4 weeks for drying. Overly trowelled plaster should be brushed down with a stiff brush. Maximum permitted weight when tiling on plaster coated with Waterproofing Paste is 20kg/m<sup>2</sup>.

#### PLASTERBOARD

Boards fixed to timber studwork must be the correct thickness, securely fixed and rigid. For boards bonded to solid walls, allow the board adhesive to fully set before tiling. Maximum permitted weight when tiling onto bare plasterboard coated with Waterproofing Paste is 32kg/m<sup>2</sup>.

#### TILE BACKER BOARDS

Ensure the boards are installed as instructed by the manufacturer. Boards fixed to timber studwork should be the correct thickness, securely fixed and rigid. For boards bonded to solid walls, allow the adhesive to fully set before tiling, and use any mechanical fixings as specified by the manufacturer. Proprietary boards will have varying weight limits – consult the manufacturer for details.

### Guidance notes on suitable floor backgrounds

#### CEMENT:SAND SCREED

Allow new screeds to dry for at least 3 weeks. For proprietary screeds, follow the manufacturer's recommendations for preparation and drying times.

#### HEATED CEMENT:SAND SCREED

New screeds must be commissioned from 3 weeks after screed installation and before work commences. Heat slowly at a maximum rate of 5°C per day until the maximum operating temperature is reached. Hold this temperature for 3 days before allowing the screed to cool to room temperature. For proprietary screeds, follow the manufacturer's recommendations for commissioning and preparation.

Switch off underfloor heating 48 hours prior to commencing work.

#### CONCRETE

Allow new concrete to cure before being subjected to continuous air drying in good conditions for at least 6 weeks. Power floated concrete should be mechanically prepared to achieve a clean, sound, micro-textured, dust-free surface.

#### CALCIUM SULPHATE/ANHYDRITE SCREEDS

All laitance and surface contaminants must be completely removed. The screed must be confirmed adequately dry ( $\leq 75\%$  RH).

#### HEATED CALCIUM SULPHATE/ANHYDRITE SCREEDS

All laitance and surface contaminants must be completely removed. New heated screeds must be commissioned from 7 days after screed installation and before work commences. The screed should be heated slowly and in accordance with the recommendations of the screed manufacturer.

The screed must be confirmed adequately dry ( $\leq 75\%$  RH). Switch off underfloor heating 48 hours prior to commencing work.

#### EXISTING CERAMIC, PORCELAIN, AND NATURAL STONE TILES

Must be in good condition, free from contaminants and well bonded to a floor containing an effective structural damp proof membrane. Ensure the existing structure can take the additional weight.

#### TILE BACKER BOARDS

Must be installed as instructed by the manufacturer and be securely fixed to rigid, suitable, prepared bases. Where boards have been installed on solid bases using tile adhesive, ensure the adhesive has fully set before commencing work.

## Application

Kelmores's Waterproofing Paste is ready to use and must be used in conjunction with Kelmores's reinforcing tape and preformed corners when waterproofing backgrounds. Please follow the application instructions below:

### 1. Fit the preformed corners.

- Apply Waterproofing Paste directly to the background, ensuring the area covered is slightly wider than the surface area of the preformed corner.
- Press the preformed corner firmly into the wet paste, ensuring it is fully embedded, sits flat, and has good contact. Remove any excess paste from the edges.
- Repeat this process until all preformed corners have been installed.

### 2. Tape all junctions, board joints, pipe outlets and fixing points.

- Starting with the junctions where the walls meet the floor, measure and pre-cut lengths of Reinforcing Tape, ensuring each piece overlaps any preformed corners by at least 30mm.
- Apply Waterproofing Paste to the background where the Reinforcing Tape will be embedded, extending over any preformed corners, and ensuring the coverage is slightly wider than the width of the tape.
- Press the tape firmly into the wet paste, ensuring it is fully embedded, sits flat, and has good contact. Remove any excess paste from the edges.
- Repeat this process until all junctions, board joints, pipe outlets and fixing points have been reinforced.

### 3. Apply one coat of Kelmores Waterproofing Paste.

- Using a medium pile roller or brush, apply the paste evenly across the entire area, including the surface of the tape and corners. Do not over apply - Waterproofing Paste should be applied as a thin, uniform coat of approximately 1mm, ensuring the background is no longer visible once dry.
- Allow to fully dry for at least 3 hours before tiling.

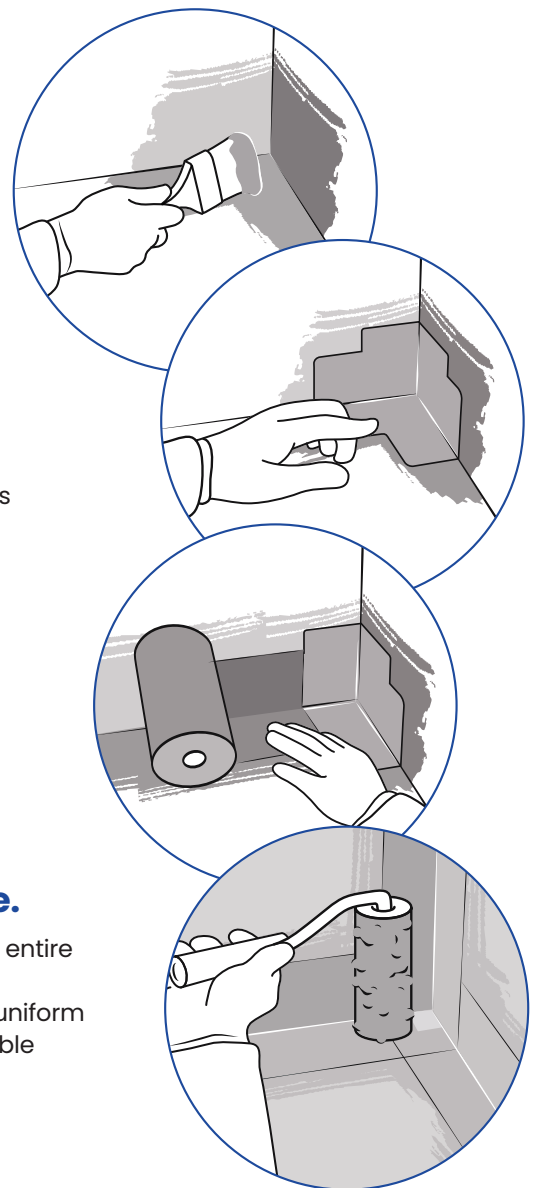

## Drying

Drying times will vary dependent on the porosity of the background, ambient temperature and humidity. When tested at 20°C, and with good airflow, Waterproofing Paste is dry and ready to receive tiles after 3 hours. Please be aware that lower temperatures, high humidity and a lack of airflow will extend the drying time.

#### NOTES:

- Kelmores Waterproofing Paste must only be used on dry, internal backgrounds and is not suitable in areas subject to rising damp or negative water pressure.
- Do not use in areas of total water immersion such as swimming pools and storage tanks.

**CLEANING** All tools should be cleaned with water after use and before the product dries.

**HEALTH AND SAFETY** For full details, please refer to the Safety Data Sheet, available at [www.kelmores.co.uk](http://www.kelmores.co.uk) or by contacting Kelmores Ltd.

**STORAGE AND SHELF LIFE** When stored in unopened packaging, off the ground, and in cool, dry conditions, this product has a shelf life of 12 months.

**BS 5385** Kelmores Waterproofing Paste should be used in conjunction with work carried out under the British Standard Code of Practice for Wall and Floor Tiling.

*All the information supplied by Kelmores Ltd is offered in good faith and is derived from the company's combined knowledge, experience and testing. Without prior notice, due to on-going research and development, the information we offer can be updated at any time. Kelmores's products are developed, tested and manufactured to consistently high standards, however, we accept no liability for any loss or damage which may arise from factors outside of our control, such as site conditions and/or the execution of the work.*